



DYN-7-100DR

MultiVoltage Dual Remote Germicidal UVC

Installation & Maintenance Instructions



UNPACKING THE UNIT

Each unit is shipped with the germicidal lamps placed in a box with protective packaging. When handling lamps take care to not touch the glass portion of the lamp with bare hands. Oils from the hands can cause “hot spots” which reduce lamp life. Handle by the porcelain caps or use a soft cloth. If you accidentally touch a lamp, clean it using a soft cloth dampened with rubbing alcohol. The lamp is fragile and proper care must be taken when removing from packaging.

The following parts are included:

- Power Supply
- Two (2) Germicidal Twin H Lamp (packed in lamp box)
- Ten (10) Sheet Metal Screws
- 4 caution labels
- Two (2) Duct-mount plates for germicidal lamps
- One (1) Magnetic Z Bracket
- Strain relief connector
- Installation & maintenance instructions

IMPORTANT: SAFETY INSTRUCTIONS IMPORTANT: Instructions de sécurité

When installing and using this electrical equipment, basic safety precautions should always be followed including the following:

1. READ AND FOLLOW ALL INSTRUCTIONS.

2. Always be sure the unit is unplugged during installation or service procedures.

3. The ultraviolet light produced by the UV lamp is harmful to your eyes. Do not look directly at the lamp. Should it become necessary to view the lamp, use UV-protected sunglasses.

Lors de l'installation et de l'utilisation de cet équipement, des précautions devront être suivies.

1- Lire et suivre les étapes attentivement.

2- Assurez vous de toujours débrancher avant l'installation ou le service.

3- Ne pas regarder la lampe directement avec les yeux. Si nécessaire de le faire, veuillez porter les lunettes de soleil contre les rayons U.V.

INSTALLATION:

- Do not locate the unit within 20” of plastic material that will be directly exposed to the UV light, such as wiring, return-side humidifier or certain types of air filters. Check with the filter manufacturer to see if their material is UV resistant. Over time, UV light may degrade plastic.
- Do not touch the glass portion of the lamps with bare hands because oils from the hands can cause “hot spots” which reduce lamp life. Handle either by the porcelain caps or use a soft cloth. If you accidentally touch a lamp, wipe it off, using a soft cloth dampened with rubbing alcohol.

INSTALLING THE GERMICIDAL UNITS

If it's necessary to route the cord from the germicidal lamp through tight spaces it can be temporarily disconnected from the power supply. If this is not necessary skip steps 1, 2, 6 and 7

1. Loosen terminal strip screws 1, 2, 3, 4 and/or 5, 6, 7, 8 and pull wires from strip that are connected to corresponding lamp cord. **Do not loosen ballast leads from terminal strip.**
2. With a pliers pinch relief connector from bottom side and pull connector and cord out of cabinet.
3. Cut out shaded area of the installation template (*See page insert*). Center the template on the longitudinal axis of the plenum and attach with tape. Trace the hole pattern and cut opening for the unit, or simply use a two inch hole saw. Repeat this step for the second UV lamp location.
4. Peel off gasket backing and attach lamp socket to duct using three long self-tapping sheet metal screws provided. Repeat this step for the second UV lamp location.
5. Find a suitable location to mount the ballast making sure supply cord to ballast will reach 120 or 240 volt power supply. Mount the ballast using two self-tapping sheet metal screws provided.
6. Route cord back to power supply and reinstall. See illustration #1 Snap strain relief back into position.
7. Holding lamps by the protective paper sleeve, plug each lamp into a lamp socket adaptor.
8. Holding lamp by the lamp socket adaptor, remove paper sleeve from lamp and carefully slide into duct through the lamp socket until it fits securely. Repeat step for second lamp.
9. **Adhere included UV Warning Label onto ductwork within six inches of each UV lamp.**

WIRING/FUSE

The multivoltage ballast is self-adjusting and operates with voltages from 120 - 240 VAC. For 120V wiring connect the black wire to L1, white wire to neutral, green wire to ground. For 240V wiring install 5 amp inline fuses then connect the black wire to L1, white wire to L2, green wire to ground. Be sure power cord is secured with included strain relief connector.

It is not necessary to cycle the germicidal air purifier with the furnace blower. You may allow unit to run continuously or have it interlocked with the furnace blower. If a 120 VAC EAC terminal is available, supply power to the unit from the EAC terminal. Connect in accordance with local wiring codes. If there is no EAC terminal, interlock the UV unit with the furnace blower using an appropriate alternate. Wire the unit in accordance with local wiring codes. After installing, verify voltage is operating between 120 - 240 VAC with air handler operating.

ACCESSORIES

Magnetic Z bracket for Germicidal Lamp Part #500483-MAG

MAINTENANCE

This maintenance schedule is only a guideline, determined by average conditions. Actual conditions will dictate the frequency of cleaning and/or replacement of lamps. Do not touch the glass portion of the lamps with bare hands because oils from the hands can cause “hot spots” which reduce lamp life. Handle either by the porcelain caps or use a soft cloth. If you accidentally touch a lamp, clean it using a soft cloth dampened with rubbing alcohol.

CLEANING THE LAMPS - Recommended interval: 12 months

1. Disconnect power to the unit.
2. Remove lamp from unit by holding the lamp socket adaptor and pull away from lamp socket.
3. Unplug the lamp from the lamp socket adaptor.
4. Using a soft cloth moistened with rubbing alcohol, wipe down the lamp. If there is a large build-up of dust particles, you may wish to use a can of air first. Always handle lamp by the end cap.
5. Plug the lamp back into lamp socket adaptor.
6. Carefully slide lamp into duct through lamp socket until it fits securely.
7. Repeat the above steps 2 - 6 for second lamp.
8. Supply power to 24 V power supply.

REPLACING THE LAMPS - Recommended interval: 24 months

Replacement lamps are available through your HVAC contractor.

Follow above procedure except #4 where you replace the lamp instead of cleaning it. (Note: standard off-the-shelf lamps are not compatible with this unit. Use of improper lamps will void warranty.)

TROUBLESHOOTING

- With the selector switch in the ON position, the LED should light when power is supplied to the unit. **If the LED does not light with switch in the On position:**

1. Check to be sure there is power to the unit.
2. Be sure lamp connectors are fastened securely.
3. If the LED still does not light, replace lamp(s).
4. If still not operating, replace ballast.

Note: Standard off-the-shelf lamps are not compatible with this unit. Use of improper lamps will void warranty.

WARRANTY

All electronic components carry a lifetime warranty to the original homeowner. In addition there is a four year warranty from the date of installation for any subsequent owner. The manufacturer reserves the right to send replacement parts or to replace the unit at its discretion. This warranty does not cover any labor or damage resulting from improper installation or abuse. Use of any lamp other than a genuine PremierOne lamp designed for this device will void the warranty.

The original lamps are warranted for a period of two years. This warranty does not cover lamps broken during shipping, installation or as a result of improper handling.

All returns are routed through your contractor/wholesaler and must be approved and accompanied by an RGA#.

The limited warranties described above are in lieu of any other warranty, whether expressed or implied, written or oral (including any warranty of merchantability or fitness for a particular purpose.) This warranty gives you specific legal rights and you may also have other rights which vary from state to state.

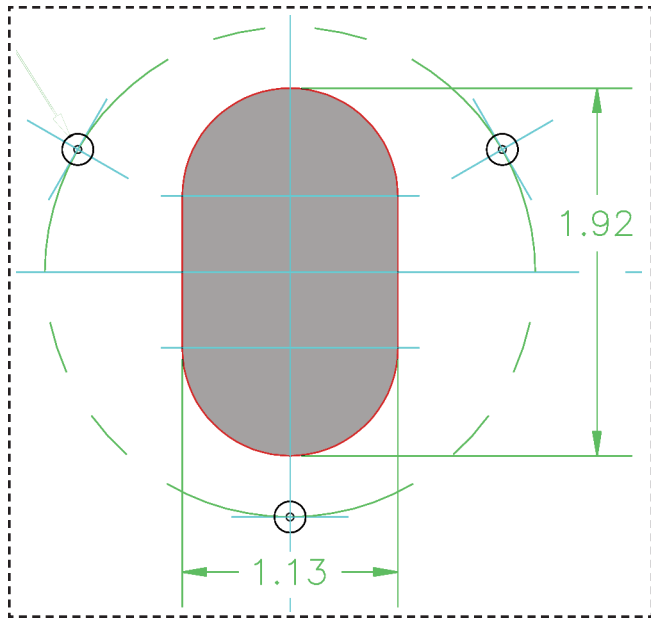

1. Cut out area of template indicated by the dotted line.
2. Cut out grey shaded center hole.
3. Place template on the return plenum of the HVAC system and trace the hole pattern.
4. Cut opening for the unit.
5. Install unit into air duct using the three self-tapping sheet metal screws provided.

Photo A

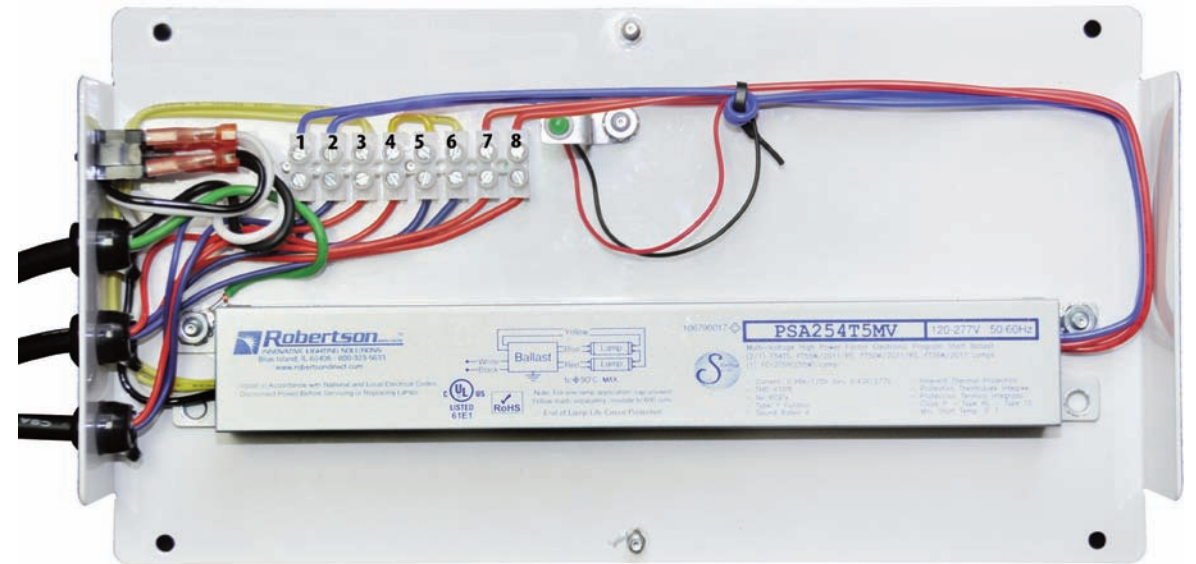

Power Supply Dimensions:
Size (L x W x D)
10.625h x 5.75w x 1.75 d

Lamp Socket Dimensions:
Size (L x W x D)
3" Round x 2"

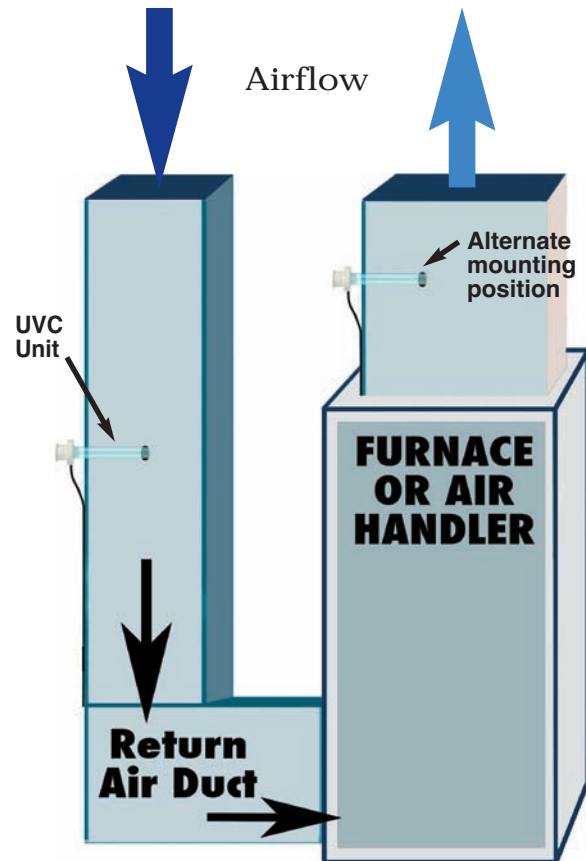

For Dual lamp operation connect matching colored lamp wires to terminals.
Lamp A Blue 1-2 Red 3-4
Lamp B Blue 5-6 Red 7-8

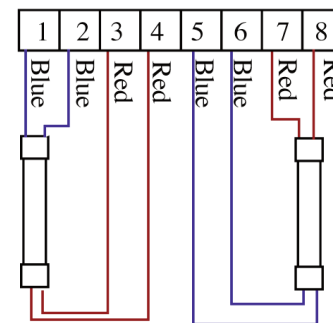

#1

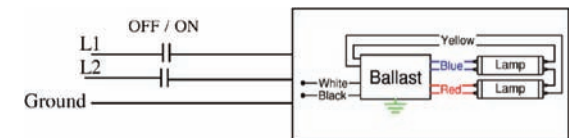

#2

For Technical Support Call (800)578-7873

© 2012 Form DYN-209 (06/12)